



350-Watt XENON Searchlight



Distance Serviced	1 lux at 5002 meters
Beam Intensity	<u>25</u> Million Candela
Beam Speed	12° per sec (Fast/Horiz.) 3° per sec (Slow/Horiz.)
Color Temperature	6000 Kelvin
Lamp	350 Watt , Xenon Short Arc
Voltage	115VAC/7 Amps <i>or</i> 230 VAC/3.5Amps; 50/60HZ
Horizontal Span	Beyond full circle, 385° with sliding stop
Vertical Span	+35° to -35°
Environmental Protection	IP56
Temperature Range	-35 °C to +55 °C
Electric Beam-Focus Focus	External knob allows manual beam-size focus capability in the event of motor failure
Controls	Proportional-Speed Joystick Control (Multiple joystick operation and Weatherproof)
Finish	Marine Grade Aluminum and Stainless Steel, Salt-Resistant, Scratch-Resistant Powder Coat
Reflector	Bullet-Resistant, Precision Electroformed, Nickel Material

OPTIONS

Anti-icing Heaters	Thermostatically-controlled heaters prevent Ice Build-up.
Azimuth Indicator	LCD Panel displays horizontal aiming position in degrees.
Detachable IR Filter:	Provides covert surveillance when used with lowlight cameras and NVG's.
LED Hybrid:	Auxiliary LED's project a "Wall of Light", which illuminates wide areas close to the vessel, where the xenon beam cannot service. See Page 3 for details.
High Powered Strobe	Disorients and denies night vision of intruder and transforms searchlight into a Nonlethal Weapon
NightFINDER™	Embedded thermal camera enhances night vision capability, and the searchlight beam and camera track on the same target. Reference last two pages
SmartVIEW™	Control System provides Digital BUS Network, and TCP/IP Interface allows Remote Computer Control. Protocols supported: ONVIF, Pelco-D, NMEA 0183 and C&F's own Protocol

Lighting the way forward since 1894

350 Watt Dimensions in inches (mm)

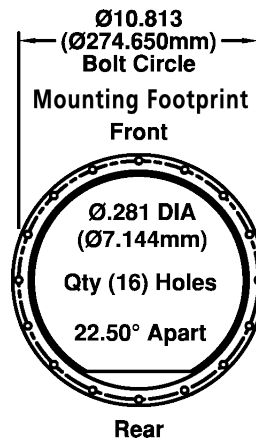
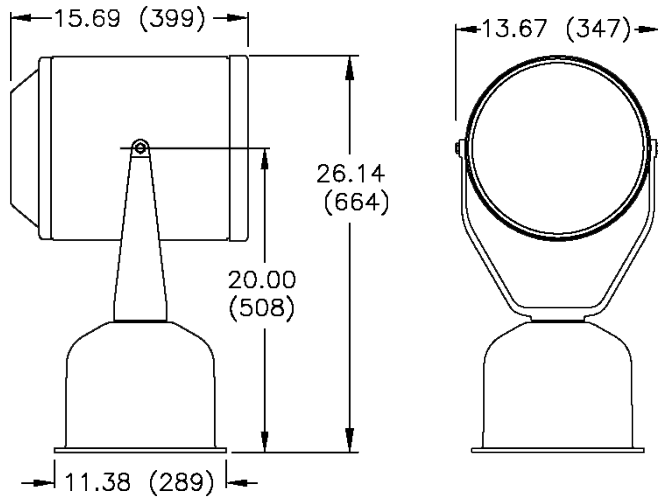

Optional Inverted Mounting Available
NOTE
 Must be specified when ordered

Power Supply: Compact Electronic Current-Regulated Supply. Regulated Current increases lamp-life by keeping lamp current constant despite voltage input changes. Solid State Electronics includes Universal Power Input Feature, providing 115 Volts AC and 230 Volts AC inputs on the same printed circuit board. Current dimming switch adjusts amperage throughout a continuous spectrum.

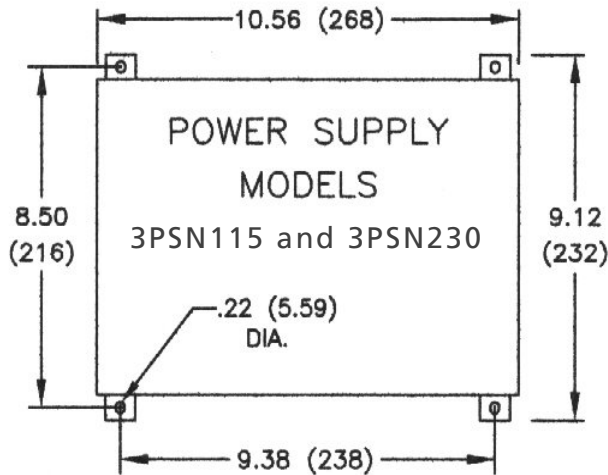

Power Supply 3PSN115 or 3PSN230
 Power Supply Weight = 7.5lb (3.4kg)

Joystick Control Stations: Remote control functions include Lamp ON/OFF, Electric Beam-size Focus, and Advanced Joystick which controls Speed and Direction simultaneously with one hand... "move the joystick to the first position and it will move slowly, move it further and it will go faster." One Master Station (C4-1-1) is required with each system, and any number of Secondary Stations, indoor (C4-1M-1) and/or outdoor (C4E1M-1-2), can be added. If you desire an outdoor Secondary Station, not flush-mounted, but in a Weatherproof Box, specify C4E1M (consult Factory for Dimensional Data).

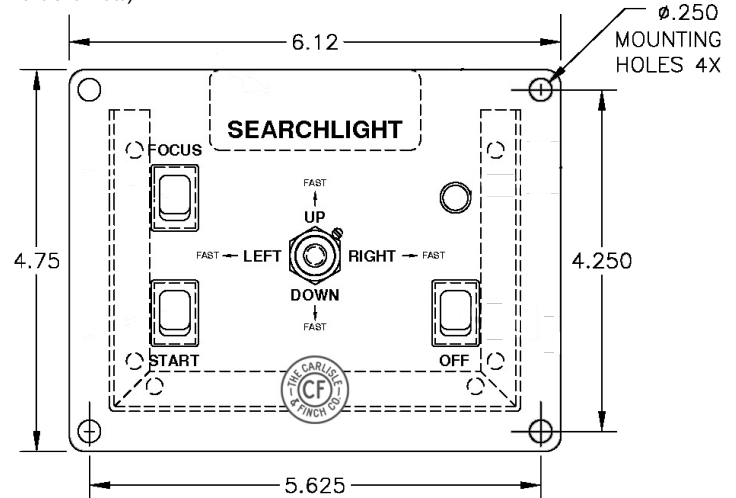

C4-1-1 Master Station.....Depth = 6.5in (166mm)
 C4-1M-1 and C4E1M-1-2 Secondary.....Depth = 3.5in (89mm)

Searchlight Chrome or Powder Coat	Power Supply 115VAC or 230VAC	Master Station (Indoor)	Secondary Station (Indoor)	Secondary Station (Outdoor)
XY3CDE-24BRF3 or XY3EDE-24ARF3	3PSN115 or 3PSN230	C4-1-1	C4-1M-1	C4E1M-1-2

How to specify searchlight system... read across table and select one searchlight, one power supply, one Master Joystick Controller and any number of optional Secondary Joystick Controllers.

Sample Specification

A 350 Watt Searchlight with Powder Coat Finish, 230 VAC Power Input and two flush-mounted Joystick Control Stations (one inside and one outside in the weather) the model numbers are as follows:

(1) **XY3EDE-24ARF3** Searchlight, (1) **3PSN230** Power Supply, (1) **C4-1-1** Master Station and (1) **C4E1M-1-2** Secondary Station

Note: Consult Factory for model numbers of optional Strobe, NightFINDER™, Anti-icing Heaters, Azimuth Indicator, SmartVIEW, etc. features.

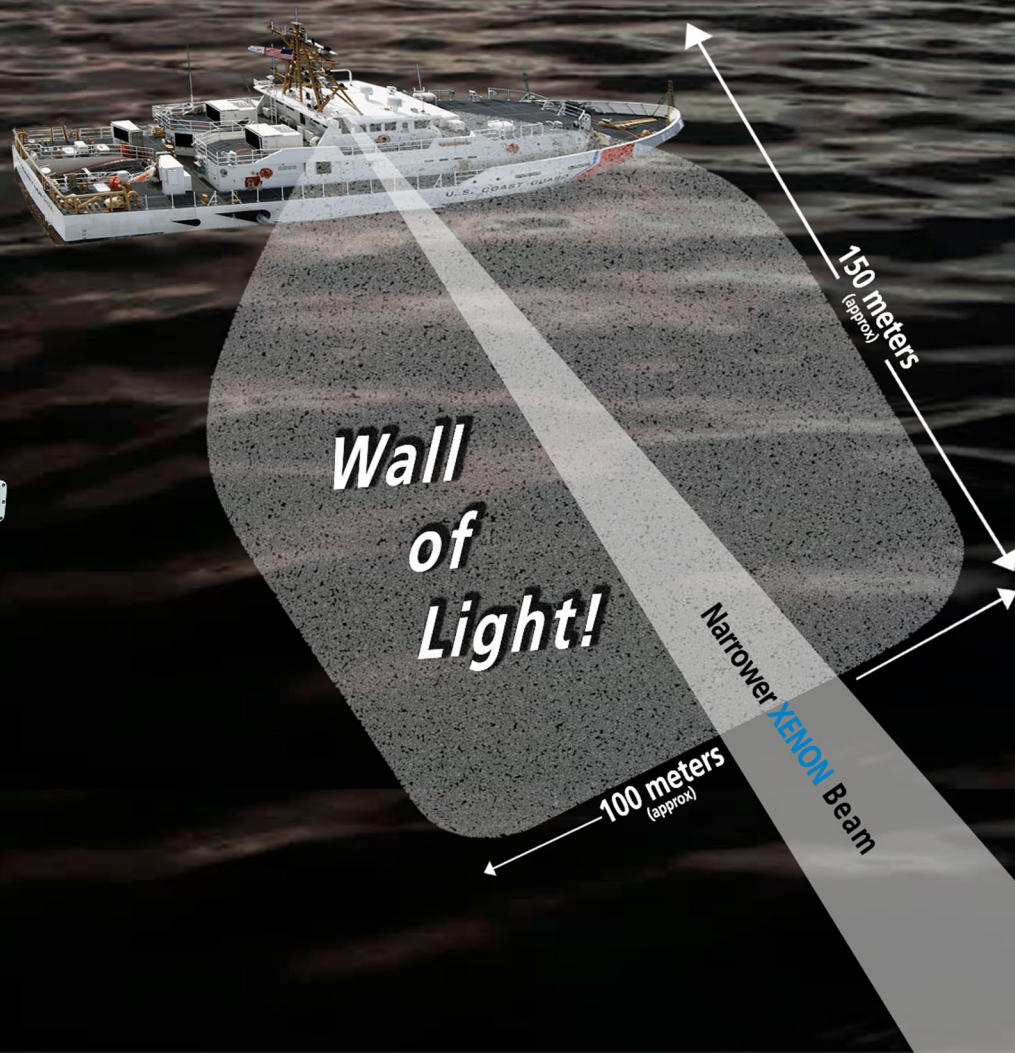

“Auxiliary LEDs illuminate wide areas at close range, where the narrower Xenon beam cannot strategically service”

Imagine a passenger suddenly falls overboard a marine vessel. Using the auxiliary LEDs for **Search and Rescue**, an operator instantly directs a powerful **“Wall of Light,”** wider than a football field, anywhere around the vessel to rescue the passenger.

The **“Wall of Light”** is extremely effective for **Vessel Interdiction, Docking, Seeing Workers at Night, etc.** Multiple light technologies combined into one versatile product, provide strategic **LED** wide-beam Illumination and powerful **XENON**, , long-distance search capability.

NightFINDER™

A Total Navigation & Security System

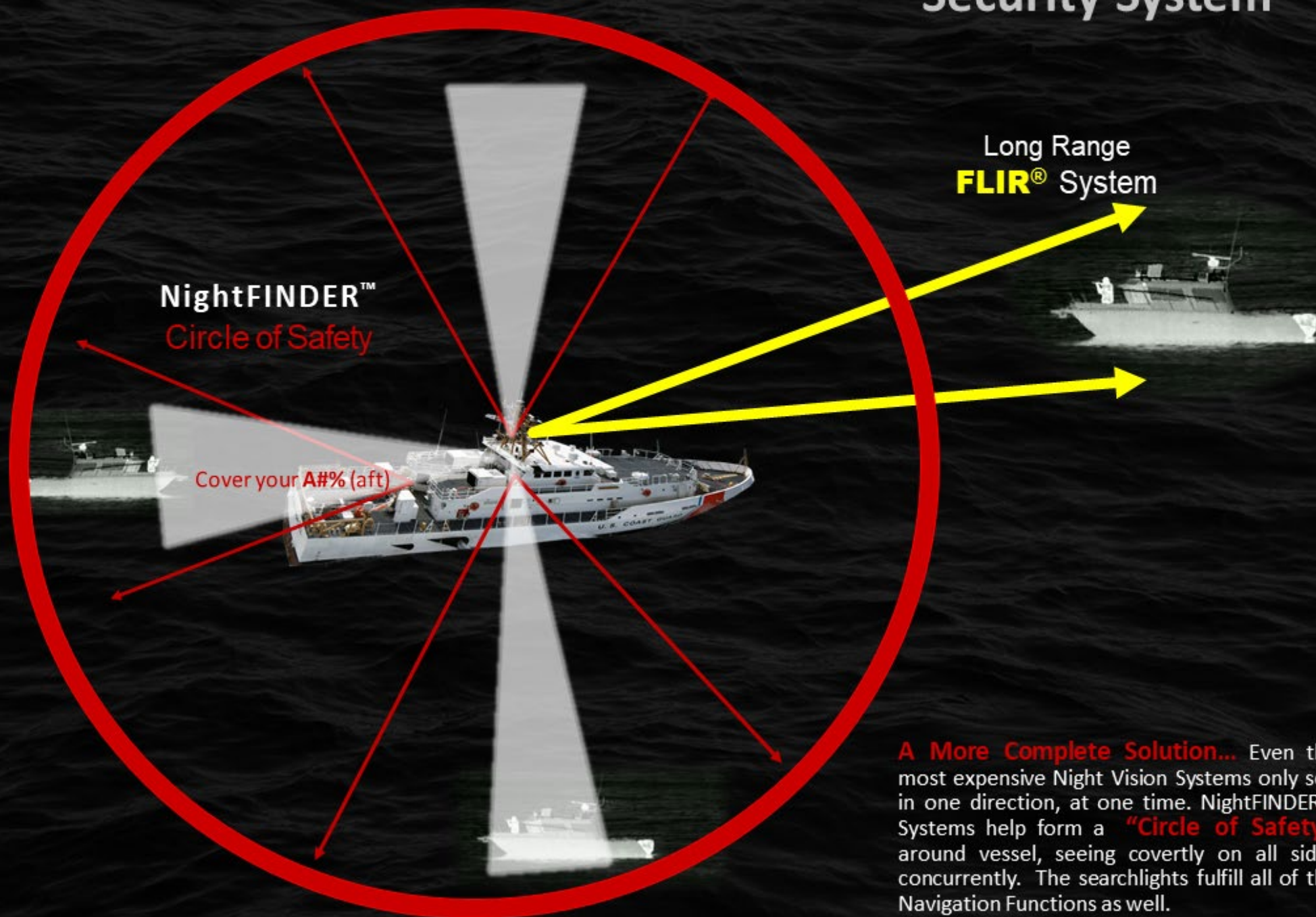

A More Complete Solution... Even the most expensive Night Vision Systems only see in one direction, at one time. NightFINDER™ Systems help form a "Circle of Safety" around vessel, seeing covertly on all sides concurrently. The searchlights fulfill all of the Navigation Functions as well.

NightFINDER™ ... a "Covert Targeting Device"

Strobe blinds and
disorients Intruder with
Nonlethal Force!



Powerful Nonlethal
Weapon

STROBE

Thermal Camera



Camera is used as **Covert Targeting Device**

"Operator covertly scans horizon with camera, and after intruder is spotted, searchlight instantly illuminates the target."