



500-Watt XENON Searchlight

U.S. Coast Guard NSN 6230-01-270-3725



Distance Serviced	1 lux at 6708 meters
Beam Intensity	45 Million Candela
Beam Speed	25° per sec (Fast/Horiz.) 3° per sec (Slow/Horiz.)
Color Temperature	6000 Kelvin
Lamp	500 Watt , Xenon Short Arc
Voltage	115VAC/15 Amps <i>or</i> 230 VAC/8 Amps; 50/60HZ
Horizontal Span	Beyond full circle, 385° with sliding stop
Vertical Span	+35° to -35°
Environmental Protection	IP56
Temperature Range	-40 °C to +55 °C (Survivability down to -46.8 °C)
Electric Beam-Focus Focus	External knob allows manual beam-size focus capability in the event of motor failure
Controls	Proportional-Speed Joystick Control (Multiple joystick operation and Weatherproof)
Finish	Marine Grade Aluminum and Stainless Steel, Salt-Resistant, Scratch-Resistant Powder Coat
Reflector	Bullet-Resistant, Precision Electroformed, Nickel Material

OPTIONS

Anti-icing Heater	Thermostatically-controlled heater prevents ice build-up in cold climates (motorized base-only)
Azimuth Indicator	LCD Panel displays horizontal aiming position in degrees (motorized base-only)
Detachable IR Filter	Provides covert surveillance when used with lowlight cameras and NVG's [Night Vision Goggles].
High Powered Strobe	Disorients and denies night vision of intruder and transforms searchlight into a Nonlethal Weapon
NightFINDER™	Embedded thermal camera enhances night vision capability, and the searchlight beam and camera track on the same target. Reference last two pages
SmartVIEW™	Control System provides Digital BUS Network, and TCP/IP Interface allows Remote Computer Control. Protocols supported: ONVIF, Pelco-D, NMEA 0183 and Carlisle & Finch's own Protocol

Lighting the way forward since 1894

Electric Joystick Control Dimensions

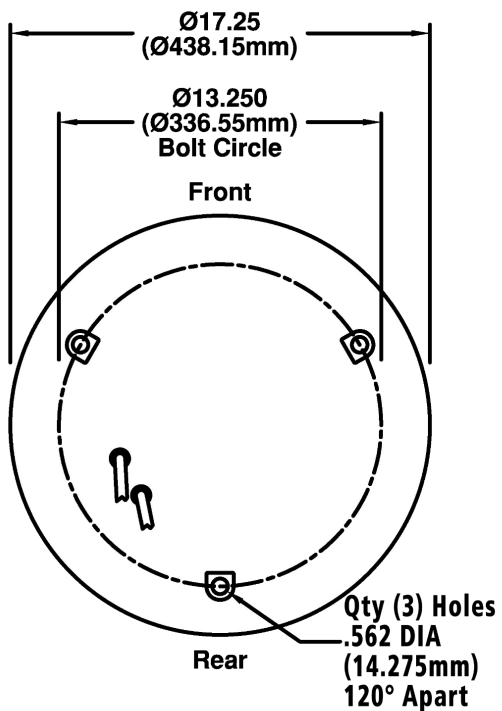
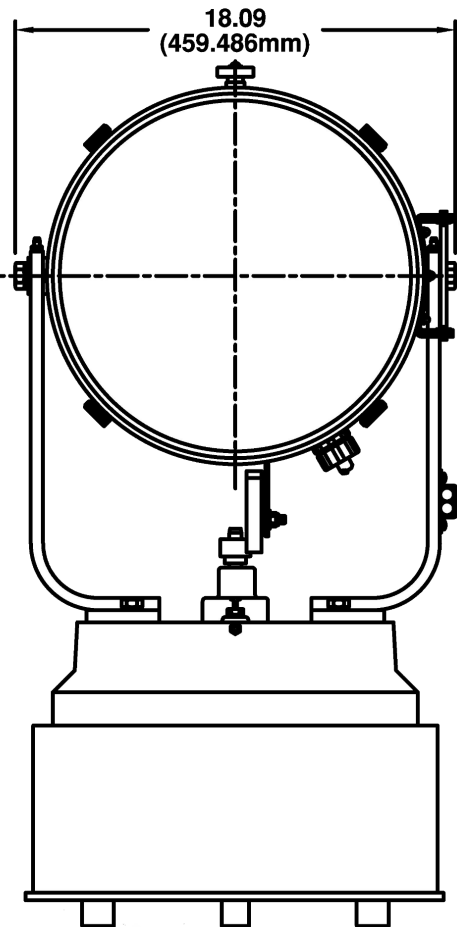
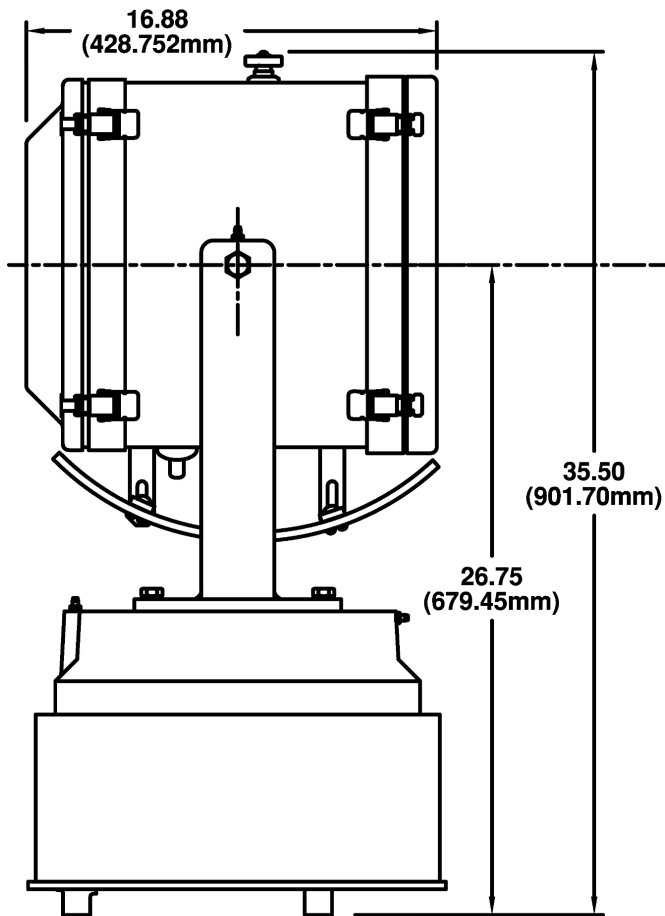



Electronic Power Supply with Multi-Board Safety Back-up

500-Watt Xenon Power Supply

15% more efficient than previous models at 1/3 of the weight & size

FEATURES

- § 120 & 230 volt models available
- § Backward compatible with previous generation Power Supplies
- § DC Output for 'Wall of Light' LEDs
- § Improved efficiency
- § Integrated Hour Meter and Ammeter
- § Multi-board safety back-up design
- § Outdoor models available
 - *Special Order Upon Request*
- § Small footprint
- § Lightweight Design



Two (2) electronic boards in parallel provide immediate safety back-up

MODEL

- | | |
|---------------|---|
| § 6PSN115 | 115 VAC, Indoor Mount, Manual Control |
| § 6PSN230 | 230 VAC, Indoor Mount, Manual Control |
| § 6PSN115DE-L | 115 VAC, Indoor Mount, Remote Electric Control, LED Modules |
| § 6PSN230DE-L | 230 VAC, Indoor Mount, Remote Electric Control, LED Modules |
| ○ K68102 | Deck Stand Kit - <i>Special Order Upon Request</i> |

Multi-Board Safety Back-up Feature: C&F's unique design has multiple electronic boards connected in parallel that provides built-in redundancy. If one board fails, the searchlight remains operational in Back-Up Mode. This feature ensures searchlight reliability and is not offered by any other searchlight company worldwide. Other searchlights suffer complete outages once an electronic board fails.

Power Supply Dimensions

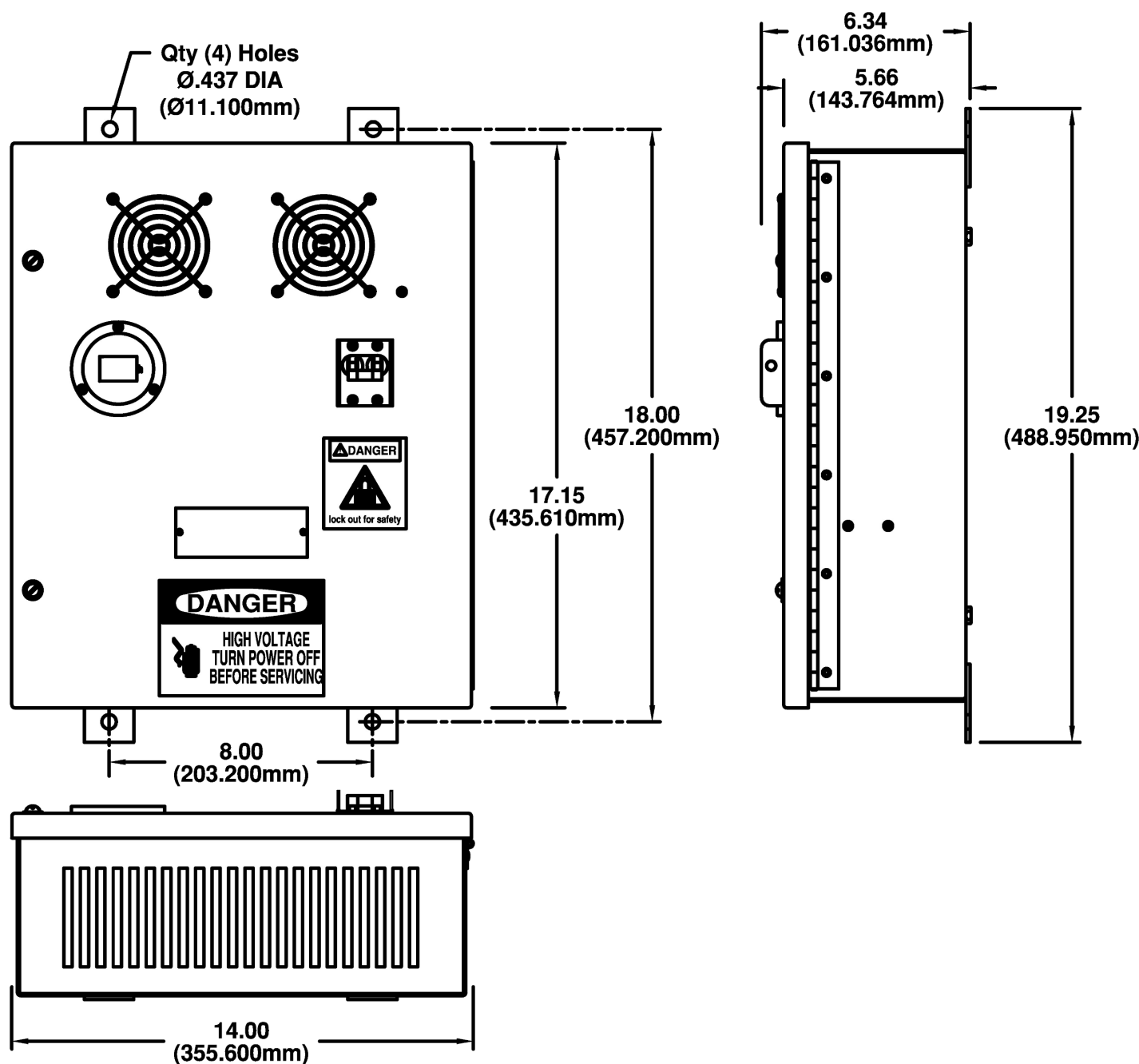

Model # Prefix	Control	Watt / AMPS
6PSN115	Manual	115/1/50-60 VAC
6PSN230	Manual	230/1/50-60 VAC
6PSNXXX-L	LED Hybrid	
6PSN115DE	Electric Joystick	115/1/50-60 VAC
6PSN230DE	Electric Joystick	230/1/50-60 VAC
6PSNXXXDE-L	LED Hybrid	

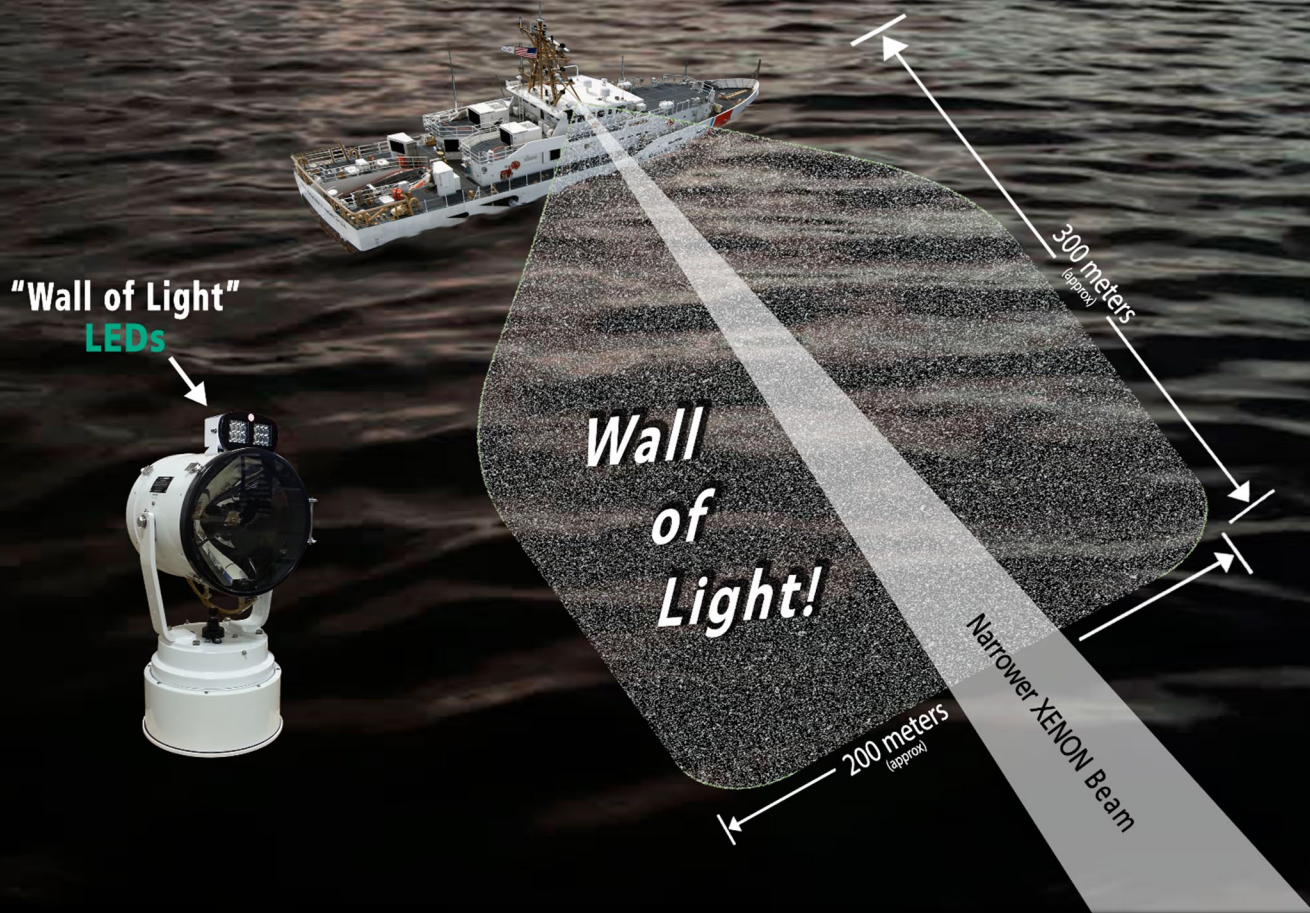

“Auxiliary **LEDs** illuminate wide areas at close range, where the narrower Xenon beam cannot strategically service”

Imagine a passenger suddenly falling overboard a marine vessel. Using the auxiliary **LEDs** for *Search and Rescue*, an operator instantly directs a powerful “*Wall of Light*,” wider than a football field, anywhere around the vessel to rescue the passenger.

The “*Wall of Light*” is extremely effective for *Vessel Interdiction, Docking, Seeing Workers at Night, etc.* Multiple light technologies combined into one versatile product, provide strategic **LED** wide-beam Illumination and powerful **XENON**, long-distance search capability.

Controller Dimensions

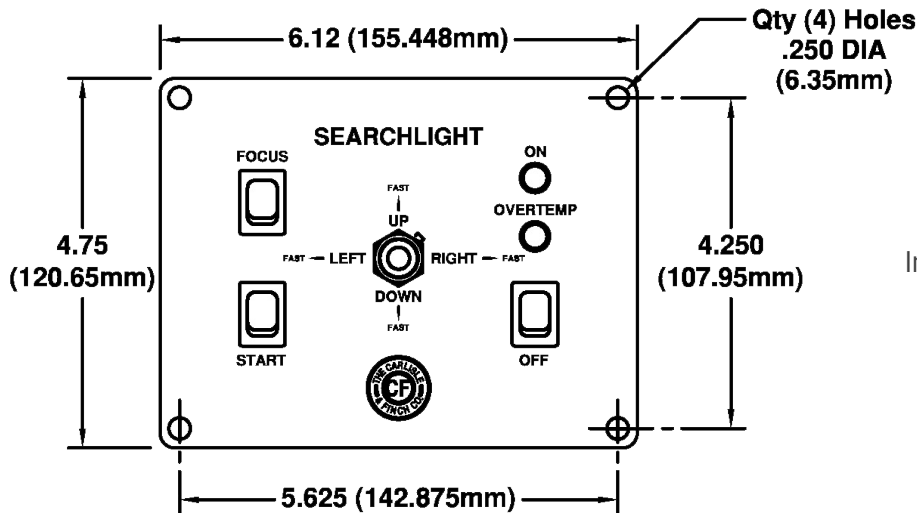

Model C4-1M-1 [Interior]
C4E1M-1-2 [Exterior]
Joystick Controller

Includes 4-Way Switch (UP, DOWN, RIGHT, LEFT, and FOUR DIAGONAL POSITIONS), Beam-Speed Dial (Changes Speed throughout a continuous spectrum) and Visible Beam ON/OFF Switch

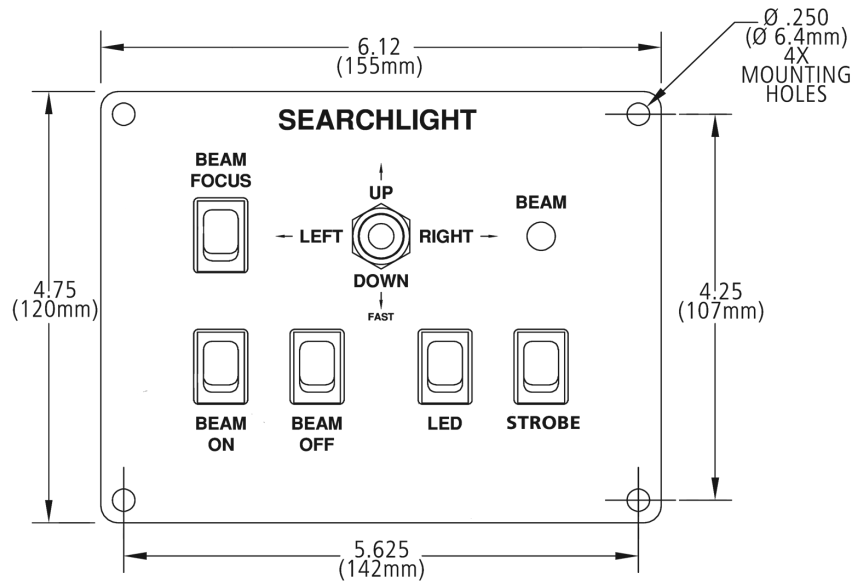

Model C6-2M-L2 [Interior]
Joystick Controller

Includes 4-Way Switch (UP, DOWN, RIGHT, LEFT, and FOUR DIAGONAL POSITIONS), Beam-Speed Dial (Changes Speed throughout a continuous spectrum) and Visible Beam ON/OFF Switch

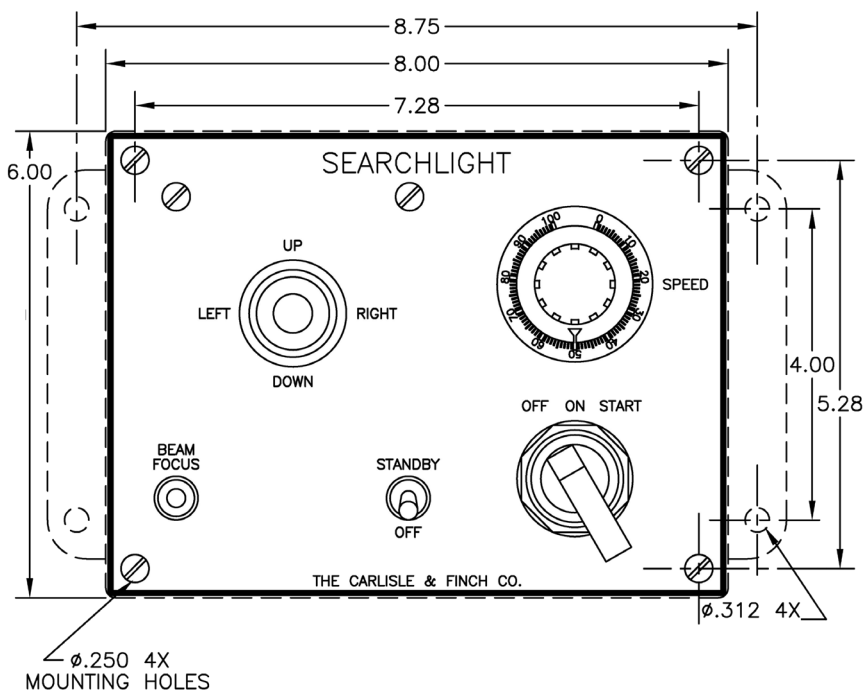

Model C5388-RSF [Interior]
Joystick Controller

Includes 4-Way Switch (UP, DOWN, RIGHT, LEFT, and FOUR DIAGONAL POSITIONS), Beam-Speed Dial (Changes Speed throughout a continuous spectrum) and Visible Beam ON/OFF Switch

How to specify Searchlight Model Number



Model # Prefix	Control	Base
X9398-[xx]RF	Joystick	Distant Electric

Options

insert the applicable letter into the model number, right of the hyphen, in alphabetical order.

1	Manual Backup	A	Azimuth Position Indicator	H	Anti-icing Heater	M	Full Manual Back-up	RF	Remote Focus
---	---------------	---	----------------------------	---	-------------------	---	---------------------	----	--------------

- n Manual Aiming Method: Handle affixed to back drum/head provides accurate aiming, while beam can be locked in horizontal / vertical positions, quickly and easily with no tools required.
- n Lowlight Camera, SmartVIEW™ Controls, Chrome, Brass Polished finish, or etc., consult factory.

Sample Specification

500 Watt Searchlight in Powder Coat Finish, with Hybrid LED 'Wall of Light' feature, Anti-icing Heaters, 115 VAC Power Input and a flush-mounted Joystick Control Stations; Indoor controller; results in the following system numbers:

- n (1) **X9398-HRF** Searchlight
- n (1) **6PSN115DE-L** Power Supply
- n (1) **C6-2M-L2** Master Indoor Station
- n (1) **K15215X** LED Hybrid 'Wall of Light'